



7460 Warren Parkway, Suite 190 Frisco, TX 75034 | 888.447.6673 | [www.somnomed.com](http://www.somnomed.com)



Welcome



**OVERVIEW** SomnoMed® MATRx™ is a revolutionary diagnostic system that combines the expertise of a sleep dentist and a sleep physician to identify patients that will benefit from SomnoDent® therapy and optimizes their effective protrusive distance. To use this medical diagnostic device a dentist assesses the patient and fits them with a temporary device which is then titrated in an attended sleep study without disturbing the patients sleep. *Caution: Federal (US) Law restricts this device to sale or on the order of a licensed dentist or practitioner.*

- WHAT'S INCLUDED**
- 2 Medium Titration Trays
  - 2 Large Titration Trays
  - Medium and Large Sizing Tools
  - 4 Brochures for Patients
  - 4 Patient Information Cards for Dentists
  - Titration Tray Manual for Dentists

**ASSESSMENT** To use this assessment tool, dental expertise is required to assess the patient's candidacy for an oral appliance. The sleep dentist fits the patient with a temporary oral appliance, proprietary to SomnoMed MATRx. Using the proprietary scale on the upper and lower Titration Trays, three measurements are taken to characterize the patient's mandibular range of motion:

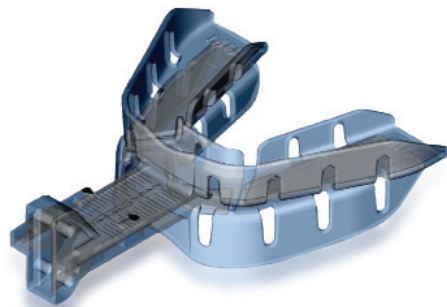

1. Habitual bite position
2. Maximum voluntary protrusion of the mandible
3. Full retrusion of the mandible

Once the temporary oral appliance is ready the patient proceeds to their local sleep center to undertake an attended polysomnographic sleep study using the SomnoMed MATRx diagnostic system.

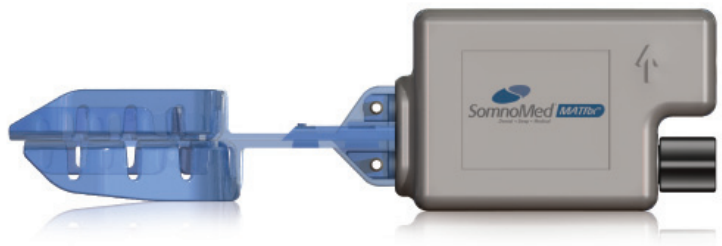

## STUDY

When the patient arrives at the sleep center a sleep technologist enters the three measurements taken by the dentist into the SomnoMed MATRx diagnostic system to ensure patient safety as the mandible is moved during the sleep study. The temporary oral appliance is then attached to an

actuator that is remotely controlled by the sleep technologist while the patient sleeps.

This enables the sleep center to conduct an oral titration sleep study in a process analogous to an industry standard CPAP titration study. During this study the mandible is progressively advanced as directed by the sleep technician until respiratory disturbances and oxy-hemoglobin desaturation are eliminated. With this information in hand both the sleep physicians and dentists can have confidence in the therapeutic outcome.



## RECOMMENDED

Patients identified as being appropriate for SomnoDent therapy return to their dentist with a prescription for a SomnoDent appliance. Included in this prescription is the optimal protrusive distance required to therapeutically manage the patient's obstructive sleep apnea. The sleep dentist uses this information to determine optimal management of the patient based on the amount of protrusion their patient needs. In some cases the patient can be moved immediately to target protrusive distance in other cases the dentist may choose to gradually advance the mandible over a number of visits. Once the dentist has determined the strategy for fitting the appliance, impressions are taken and a SomnoDent appliance is ordered for the patient.

## CLINICALLY VALIDATED

Validated in two previous studies SomnoMed MATRx patented technology was developed by Zephyr Sleep Technologies Inc. Chief Medical Officer, Dr. John Remmers. Dr. Remmers was one of the first investigators to demonstrate that sleep apnea is due to an anatomical narrowing of the pharynx. He has developed a number of medical devices to treat and diagnose this condition and remains clinically active at the Foothills Sleep Laboratory at the University of Calgary.

1. *Remotely Controlled Mandibular Positioner Predicts Efficacy of Oral Appliances in Sleep Apnea. American Journal of Respiratory and Critical Care Medicine 2004; Vol 170. pp 366–370, 2004*
2. *Mandibular advancement and obstructive sleep apnoea: a method for determining effective mandibular protrusion. European Respiratory Journal 2006; 27 1003–1009*

## ABOUT SOMNOMED

SomnoMed is a publically listed company (ASX:SOM) providing diagnostic and treatment solutions for Sleep Breathing Disorders. SomnoMed was commercialized on the basis of extensive clinical research. The company now has 11 years of clinical evidence supporting SomnoDent for the treatment of Obstructive Sleep Apnea. The company has continued to invest in research and products which fit this philosophy.

SomnoMed's proprietary materials and portfolio of patents has enabled the development of the next generation of sleep breathing disorder products. The company also operates its manufacturing facilities to international quality standard such as ISO, FDA, TGA, CE.

